

AVANT LES MARCILLY (Aube)

Section YV

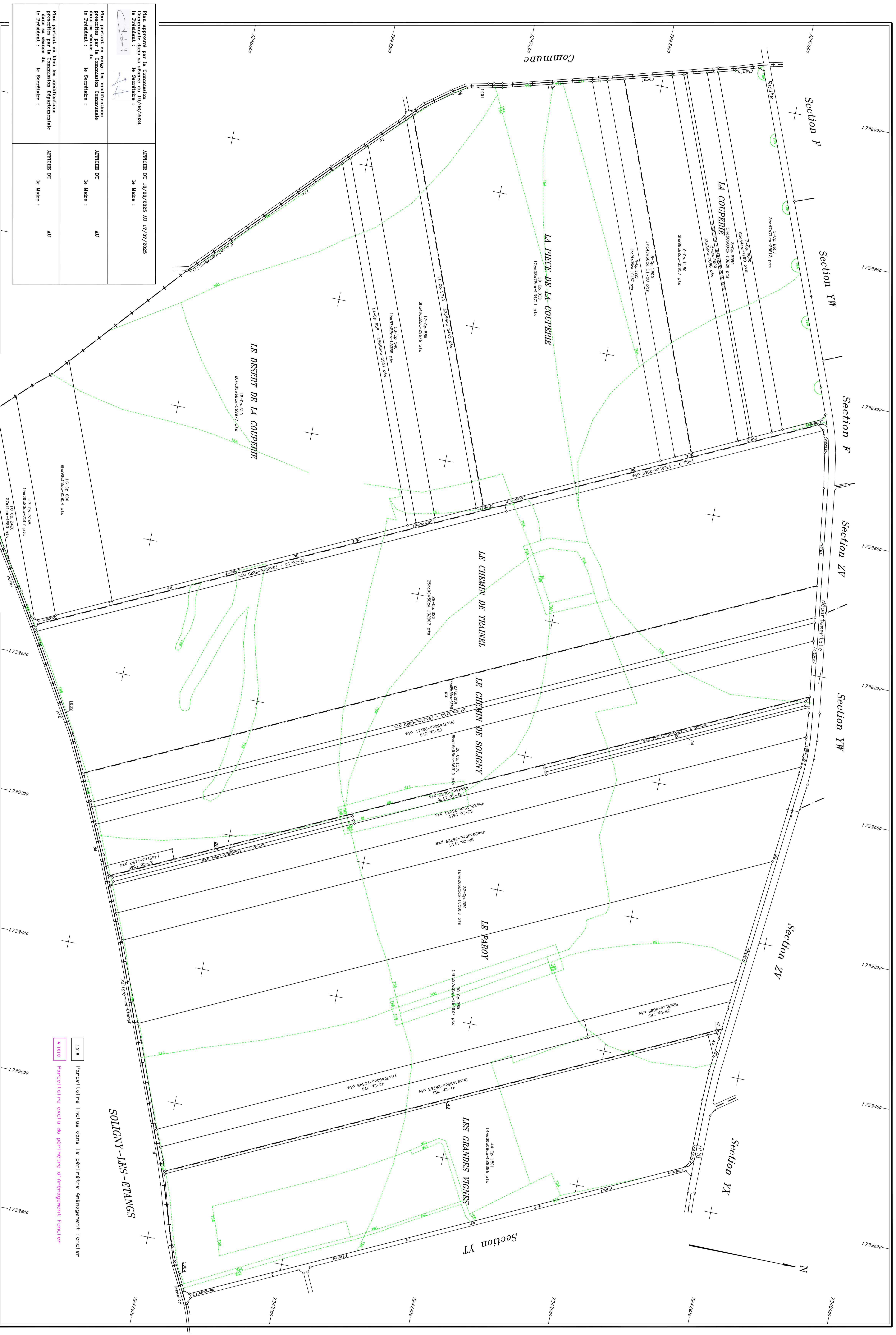

Plan approuvé par la Commission d'Aménagement Foncier et Forestier, Agricole et Piscicole le 19/06/2024	APPRISÉ DU 16/06/2025 AU 17/07/2025	le Maire :
Plan portant en l'état les modifications proposées par la Commission d'Aménagement Foncier et Forestier, Agricole et Piscicole le 17/06/2024	APPRISÉ DU 16/06/2025 AU 17/07/2025	le Maire :
Plan portant en l'état les modifications proposées par la Commission d'Aménagement Foncier et Forestier, Agricole et Piscicole le 17/06/2024	APPRISÉ DU 16/06/2025 AU 17/07/2025	le Maire :

Echelle 1/2000

A.F.A.F. AVANT LES MARCILLY
PROJET - PLAN PROVISOIRE

PARCELLES SITUÉES SUR LA COMMUNE DE AVANT LES MARCILLY

YV 1	0-2410 2812 p.m.	2417/21ca
YV 2	0-2410 2813 p.m.	2417/21ca
YV 3	0-2410 1320 p.m.	1481/21ca
YV 4	0-2410 2800 p.m.	2417/21ca
YV 5	0-2410 2814 p.m.	2417/21ca
YV 6	0-2410 2815 p.m.	2417/21ca
YV 7	0-2410 1156 p.m.	1481/21ca
YV 8	0-2410 1017 p.m.	1481/21ca
YV 9	0-2410 1017 p.m.	1481/21ca
YV 10	0-2410 1317 p.m.	1481/21ca
YV 11	0-2410 1317 p.m.	1481/21ca
YV 12	0-2410 1317 p.m.	1481/21ca
YV 13	0-2410 1317 p.m.	1481/21ca
YV 14	0-2410 1317 p.m.	1481/21ca
YV 15	0-2410 1317 p.m.	1481/21ca
YV 16	0-2410 1317 p.m.	1481/21ca
YV 17	0-2410 1317 p.m.	1481/21ca
YV 18	0-2410 1317 p.m.	1481/21ca
YV 19	0-2410 1317 p.m.	1481/21ca
YV 20	0-2410 1317 p.m.	1481/21ca
YV 21	0-2410 1317 p.m.	1481/21ca
YV 22	0-2410 1317 p.m.	1481/21ca
YV 23	0-2410 1317 p.m.	1481/21ca
YV 24	0-2410 1317 p.m.	1481/21ca
YV 25	0-2410 1317 p.m.	1481/21ca
YV 26	0-2410 1317 p.m.	1481/21ca
YV 27	0-2410 1317 p.m.	1481/21ca
YV 28	0-2410 1317 p.m.	1481/21ca
YV 29	0-2410 1317 p.m.	1481/21ca
YV 30	0-2410 1317 p.m.	1481/21ca
YV 31	0-2410 1317 p.m.	1481/21ca
YV 32	0-2410 1317 p.m.	1481/21ca
YV 33	0-2410 1317 p.m.	1481/21ca
YV 34	0-2410 1317 p.m.	1481/21ca
YV 35	0-2410 1317 p.m.	1481/21ca
YV 36	0-2410 1317 p.m.	1481/21ca
YV 37	0-2410 1317 p.m.	1481/21ca
YV 38	0-2410 1317 p.m.	1481/21ca
YV 39	0-2410 1317 p.m.	1481/21ca
YV 40	0-2410 1317 p.m.	1481/21ca
YV 41	0-2410 1317 p.m.	1481/21ca
YV 42	0-2410 1317 p.m.	1481/21ca
YV 43	0-2410 1317 p.m.	1481/21ca
YV 44	0-2410 1317 p.m.	1481/21ca
YV 45	0-2410 1317 p.m.	1481/21ca
YV 46	0-2410 1317 p.m.	1481/21ca
YV 47	0-2410 1317 p.m.	1481/21ca
YV 48	0-2410 1317 p.m.	1481/21ca
YV 49	0-2410 1317 p.m.	1481/21ca
YV 50	0-2410 1317 p.m.	1481/21ca
YV 51	0-2410 1317 p.m.	1481/21ca
YV 52	0-2410 1317 p.m.	1481/21ca
YV 53	0-2410 1317 p.m.	1481/21ca
YV 54	0-2410 1317 p.m.	1481/21ca
YV 55	0-2410 1317 p.m.	1481/21ca
YV 56	0-2410 1317 p.m.	1481/21ca
YV 57	0-2410 1317 p.m.	1481/21ca
YV 58	0-2410 1317 p.m.	1481/21ca
YV 59	0-2410 1317 p.m.	1481/21ca
YV 60	0-2410 1317 p.m.	1481/21ca
YV 61	0-2410 1317 p.m.	1481/21ca
YV 62	0-2410 1317 p.m.	1481/21ca
YV 63	0-2410 1317 p.m.	1481/21ca
YV 64	0-2410 1317 p.m.	1481/21ca
YV 65	0-2410 1317 p.m.	1481/21ca
YV 66	0-2410 1317 p.m.	1481/21ca
YV 67	0-2410 1317 p.m.	1481/21ca
YV 68	0-2410 1317 p.m.	1481/21ca
YV 69	0-2410 1317 p.m.	1481/21ca
YV 70	0-2410 1317 p.m.	1481/21ca
YV 71	0-2410 1317 p.m.	1481/21ca
YV 72	0-2410 1317 p.m.	1481/21ca
YV 73	0-2410 1317 p.m.	1481/21ca
YV 74	0-2410 1317 p.m.	1481/21ca
YV 75	0-2410 1317 p.m.	1481/21ca
YV 76	0-2410 1317 p.m.	1481/21ca
YV 77	0-2410 1317 p.m.	1481/21ca
YV 78	0-2410 1317 p.m.	1481/21ca
YV 79	0-2410 1317 p.m.	1481/21ca
YV 80	0-2410 1317 p.m.	1481/21ca
YV 81	0-2410 1317 p.m.	1481/21ca
YV 82	0-2410 1317 p.m.	1481/21ca
YV 83	0-2410 1317 p.m.	1481/21ca
YV 84	0-2410 1317 p.m.	1481/21ca
YV 85	0-2410 1317 p.m.	1481/21ca
YV 86	0-2410 1317 p.m.	1481/21ca
YV 87	0-2410 1317 p.m.	1481/21ca
YV 88	0-2410 1317 p.m.	1481/21ca
YV 89	0-2410 1317 p.m.	1481/21ca
YV 90	0-2410 1317 p.m.	1481/21ca
YV 91	0-2410 1317 p.m.	1481/21ca
YV 92	0-2410 1317 p.m.	1481/21ca
YV 93	0-2410 1317 p.m.	1481/21ca
YV 94	0-2410 1317 p.m.	1481/21ca
YV 95	0-2410 1317 p.m.	1481/21ca
YV 96	0-2410 1317 p.m.	1481/21ca
YV 97	0-2410 1317 p.m.	1481/21ca
YV 98	0-2410 1317 p.m.	1481/21ca
YV 99	0-2410 1317 p.m.	1481/21ca
YV 100	0-2410 1317 p.m.	1481/21ca

Parcelles incluses dans le périmètre Aménagement Foncier
Parcelles exclues du périmètre d'Aménagement Foncier